

30 Austen Place, Lower Turk Street, Alton, Hampshire
Approximate Gross Internal Area
61 Sq M/657 Sq Ft

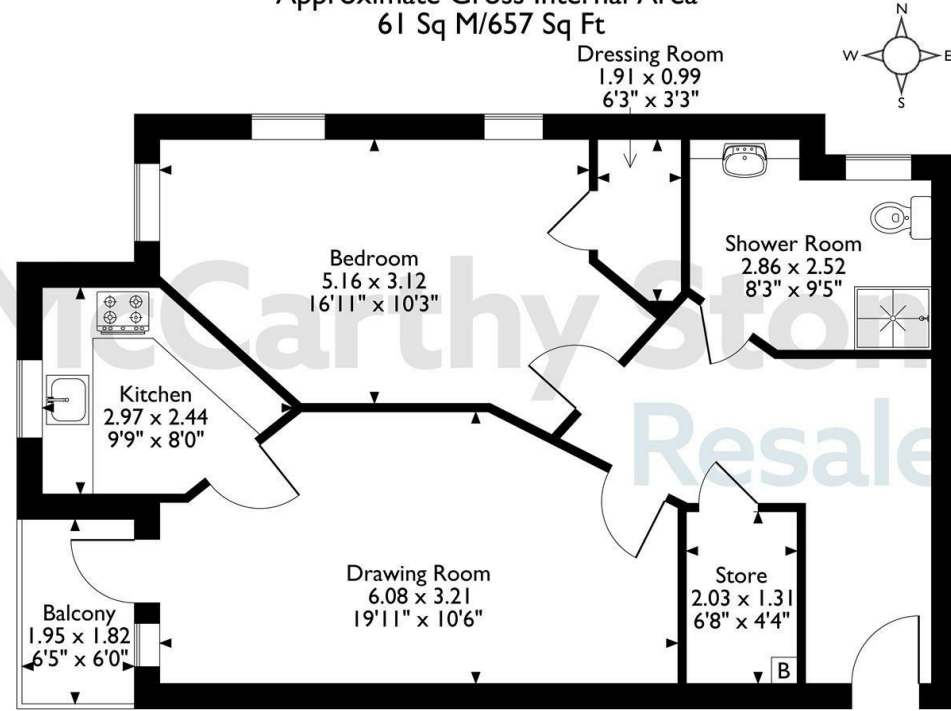

The position & size of doors, windows, appliances and other features are approximate only.
© ehouse. Unauthorised reproduction prohibited. Drawing ref. dig/8654731/DST.

Council Tax Band: B



Energy Efficiency Rating		
	Current	Potential
Very energy efficient - lower running costs		
(92 plus) A		
(81-91) B	87	87
(69-80) C		
(55-68) D		
(39-54) E		
(21-38) F		
(1-20) G		
Not energy efficient - higher running costs		
England & Wales	EU Directive 2002/91/EC	

30 Austen Place

Lower Turk Street, Alton, GU34 1FZ



PRICE REDUCTION

Asking price £180,000 Leasehold

*** FIRST TWO YEARS SERVICE CHARGE PAID BY THE VENDOR ***

A well presented and spacious one bedroom apartment situated on the FIRST floor with LIFT access. This apartment boasts a walk out BALCONY from the living area, modern kitchen with INTEGRATED appliances, a generously sized double bedroom, wet room and store area. Austen Place, a McCarthy Stone retirement development is nestled in Alton and boasts an on-site restaurant, landscaped gardens and Homeowner's lounge where SOCIAL events take place.

Entitlements Advice and Part Exchange available

Call us on 0345 556 4104 to find out more.

resales@mccarthyandstone.co.uk | mccarthyandstoneresales.co.uk

This floor plan is not drawn to scale and is for illustrative purposes only. Any measurements, floor areas (including any total floor area), openings and orientation are approximate and for guidance only. McCarthy Stone Resales do not take liability for any error, omission or misstatement. All parties must rely on their own inspections. It should not be assumed that any furniture or fittings contained in the photographs are included in any sale. All details referring to time and distances to localities are approximate. Details regarding any common charges and other applicable fees are provided by the seller and should not be relied on without verification and further checks made through a solicitor/conveyancer. Please contact the Property Consultant for further information that Appliances (including central heating) have not been tested, therefore it cannot be assumed that they are in good working order. All interested parties are advised to check availability and make an appointment before travelling to view the property to avoid disappointment or wasted time or travel expenses. The details contained within this brochure are for information purposes only and do not form part of any agreement. All purchases will be subject to contract terms. © All artwork (photos and floorplans) and written content are the sole property and copyright of McCarthy & Stone Resales Limited and are legally protected by UK & International copyright laws. Under no circumstance may you download, reproduce, publish or distribute any content for commercial purposes, without prior written permission from McCarthy Stone Resales.

McCarthy & Stone Resales Limited, Trading as McCarthy Stone Resales
Registered Office: 100 Holdenhurst Road, Bournemouth, Dorset, BH8 8AQ.
Registered in England and Wales No. 10716544



Austen Place, Lower Turk Street, Alton

1 Bed | £180,000

PRICE
REDUCED

Austen Place is a purpose built Retirement Living Plus development built by McCarthy & Stone, designed specifically for the over 70s, for those who wish to enjoy independent living but may need some extra care and support. There is an Estate Manager who leads the team and oversees the development.

Communal facilities include a Club lounge where social events and activities take place, a function room, a wellbeing suite and landscaped gardens. There are fully equipped laundry rooms and a restaurant which is table service and serves freshly prepared meals daily. If your guests wish to stay, there is guest suite accommodation which can be booked (fees apply). There is a 24 hour emergency call system provided by a personal pendant and call points in your bedroom and bathroom as well as onsite management 24 hours a day.

One hour of domestic support per week is included in the service charge at Austen Place with additional services including care and support available at an extra charge. However, this can be from as little as 15 minutes per session which can be increased or decreased to suit your needs.

Austen Place is situated a stone's throw from a Sainsbury's supermarket and a short walk from the high street, which offers a wealth of local amenities to choose from.

Entrance Hall

Front door with spyhole leads to the entrance hall, the 24 hour Tunstall emergency response pull cord system is in place. Illuminated light switches and smoke detector. From the hallway there is a door to a walk in storage and airing cupboard. Doors lead to the bedroom, living room and shower room.

Lounge

A light and spacious living area with ample room for dining. French doors open onto a walk out balcony, perfect for a bistro table to watch the world go by! Two ceiling light points, power points. TV & telephone points. Partially glazed door leads onto a separate kitchen.

Kitchen

Fully fitted modern style kitchen with a range of wall and base cabinets for ample storage and co-ordinating work surfaces. Contemporary ceiling lights. Stainless steel sink with chrome

mixer tap. There is an integrated fridge/freezer and a fitted electric oven, fitted electric ceramic hob with a steel extractor over and splashback. Electrically operated window.

Bedroom

A very generously sized dual aspect double bedroom with a number of floor to ceiling windows for ample natural light. Door leads into a walk in wardrobe with railing and shelves for plenty of clothes storage. TV and phone point and ceiling lights.

Shower Room

Modern suite comprising of; close-coupled WC, vanity wash-hand basin with fitted furniture surround including storage below, illuminated mirror cabinet with integrated shaver point and down lights over, walk-in level access shower with thermostatically controlled shower. fully tiled walls and wet room vinyl flooring, electric heated towel rail, emergency pull cord and ceiling spot light.

Service Charge (breakdown)

- Cleaning of communal windows
- Water rates for communal areas and apartments
- Electricity, heating, lighting and power to communal areas
- 24 hour emergency call system
- Upkeep of gardens and grounds
- Repairs and maintenance to the interior and exterior communal areas
- Contingency fund including internal and external redecoration of communal areas
- Buildings insurance

One hour of domestic support per week is included in the service charge

The Service charge does not cover external costs such as your Council Tax, electricity or TV. To find out more about service charges please contact your Property Consultant or Estates Manager.

Service Charge: £9,469.09 per annum (Up to financial year end 30/06/2026) Check out benefits you may be entitled to (often offset by Government Entitlements eg Attendance Allowance £3,500-£5,200)!

SERVICE CHARGE INCENTIVE: The first two years service charge to be paid by the sellers. This is calculated on the current service charge rate and based on an asking price offer being accepted. Should the offer be below asking price, it is at the vendors discretion whether the incentive will be included.

Lease Information

Lease Length: 999 years from Jan 2018

Ground Rent: £435 per annum

Ground rent review date: Jan 2033

Moving Made Easy & Additional Information

Moving is a huge step, but don't let that hold you back. We have a range of services to help your move go smoothly, including:

- FREE Entitlements Advice to help you find out what benefits you may be entitled to .
- Part Exchange service to help you move without the hassle of having to sell your own home.
- Removal Services that can help you declutter and move you in to your new home.
- Conveyancing specialists who are experienced with sales and purchases of McCarthy Stone retirement properties.

FOR MORE INFORMATION CHECK OUR WEBPAGE OR SPEAK WITH OUR PROPERTY CONSULTANT

ADDITIONAL SERVICES:

- Full Fibre Broadband available
- Mains water and electricity
- Electric room heating
- Mains drainage

